

Mögliche Antriebsanordnungen KA67 / possible drive arrangements KA67

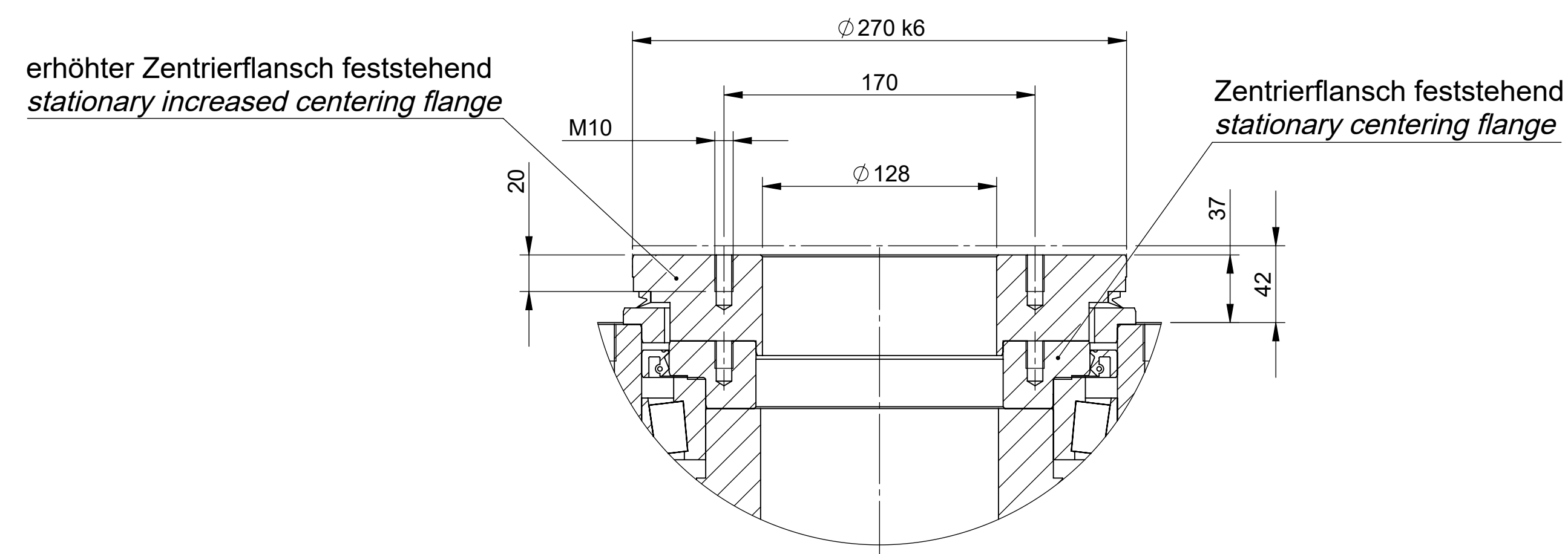

MASSSTAB / SCALE 2 : 5

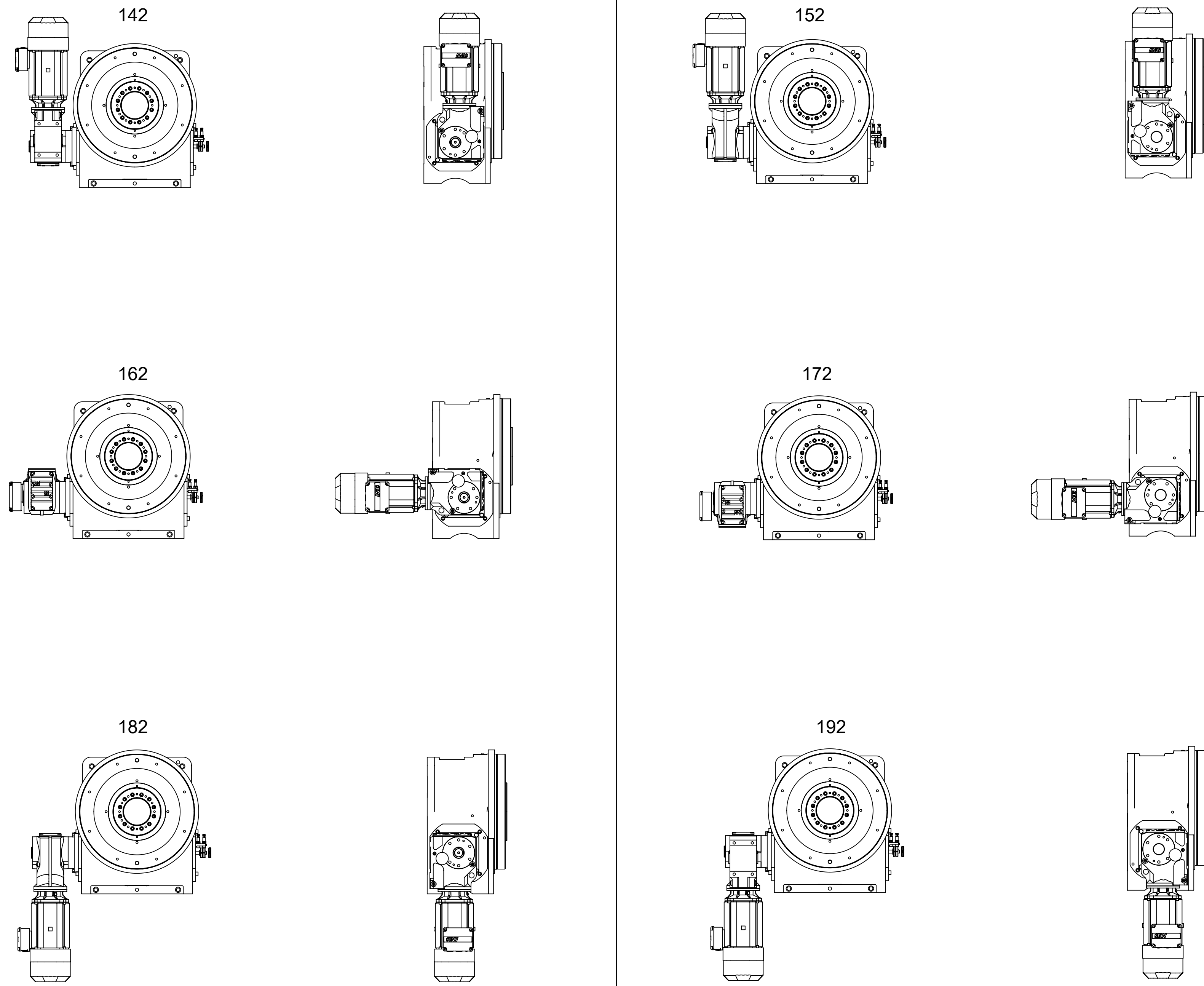
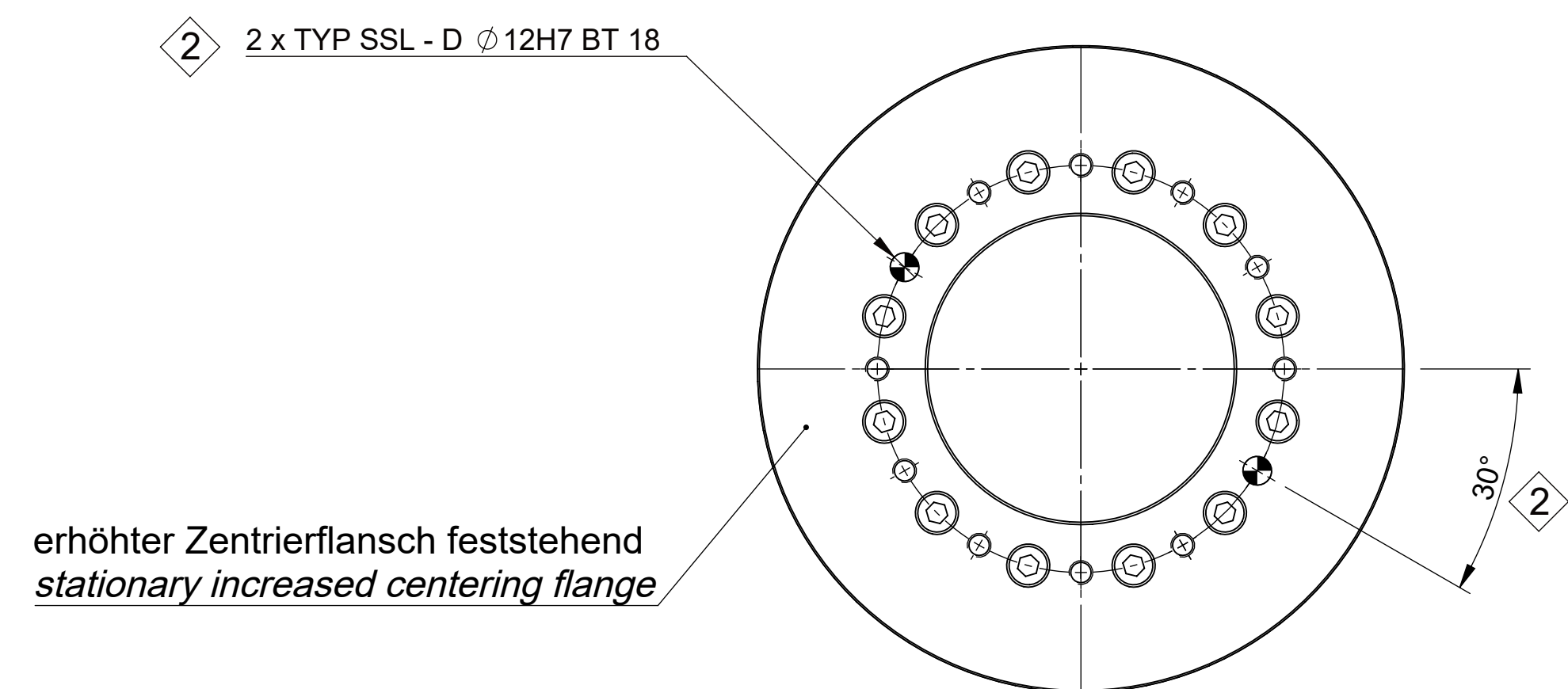

MASSSTAB / SCALE 2 : 5

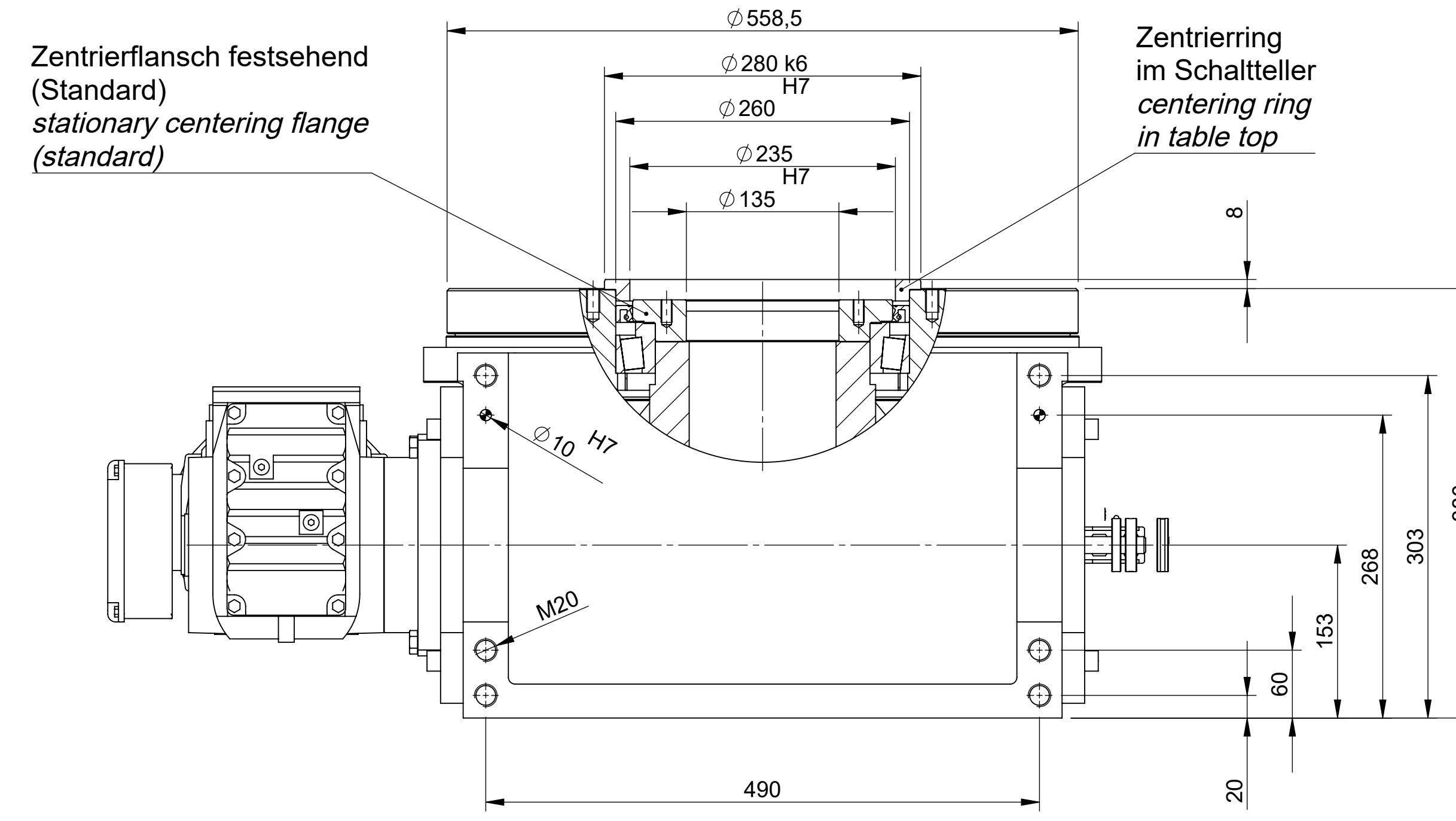

Zentrierung im Schaltteller
centering ring
in table top

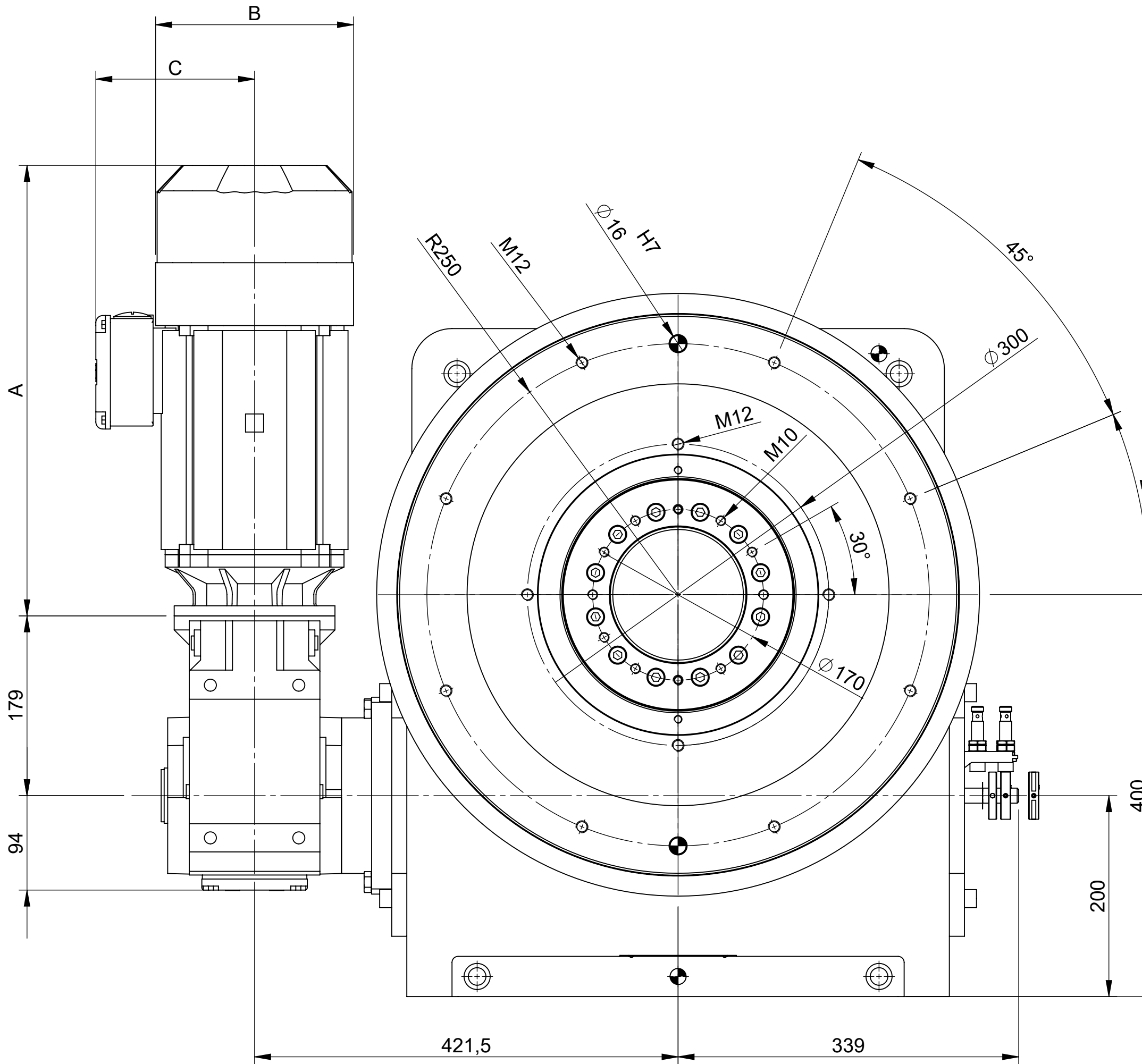

Motor Typ	A	B	C
80MK4	311	156	139
80M4	356	156	139
90S4	370	179	150
90L4	402	179	150
100LM4	449	197	158
100L4	449	197	158

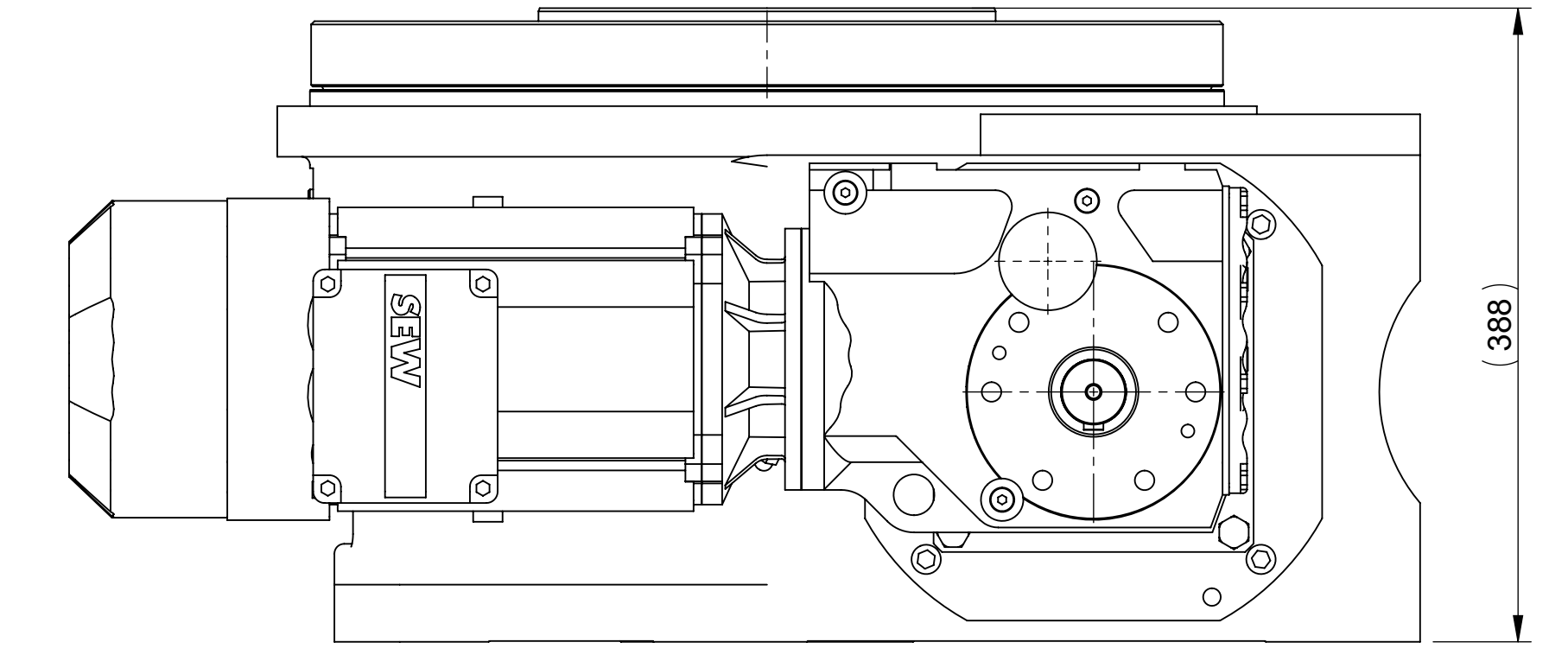

Sperrluftanschluss 0,3 bar G1/8
air purge 0,3 bar G1/8

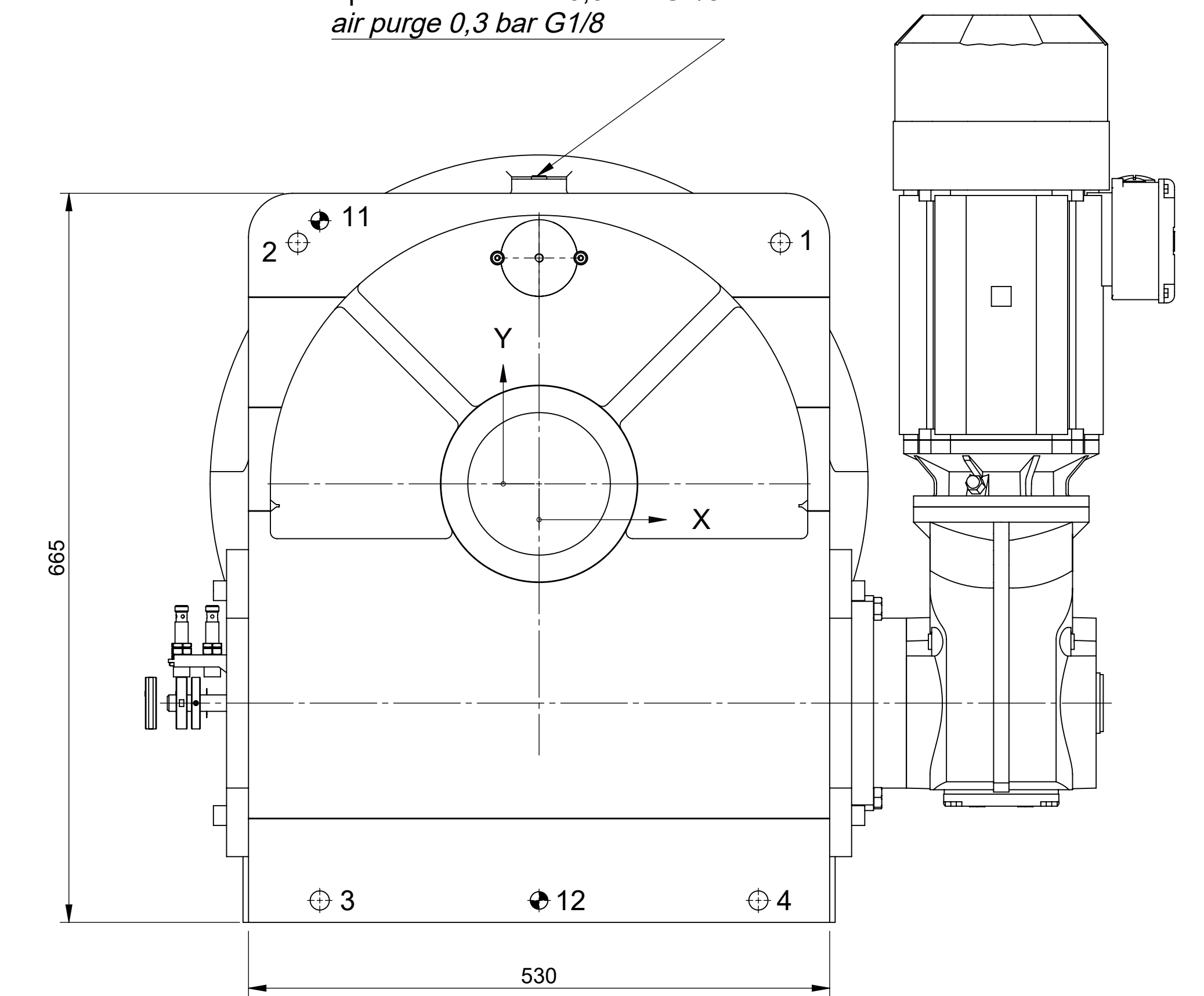

Pos.	X	Y	Beschreibung / Description
1	220	220	
2	-220	220	TYP S - D1 $\varnothing 17,5$ (BT 35) - D2 $\varnothing 26\text{ T } 5 - \varnothing 0,2$
3	-200	-380	
4	200	-380	
11	-200	240	TYP SSL - D $\varnothing 16\text{ H7 BT } 35 - \varnothing 0,02$
12	0	-380	

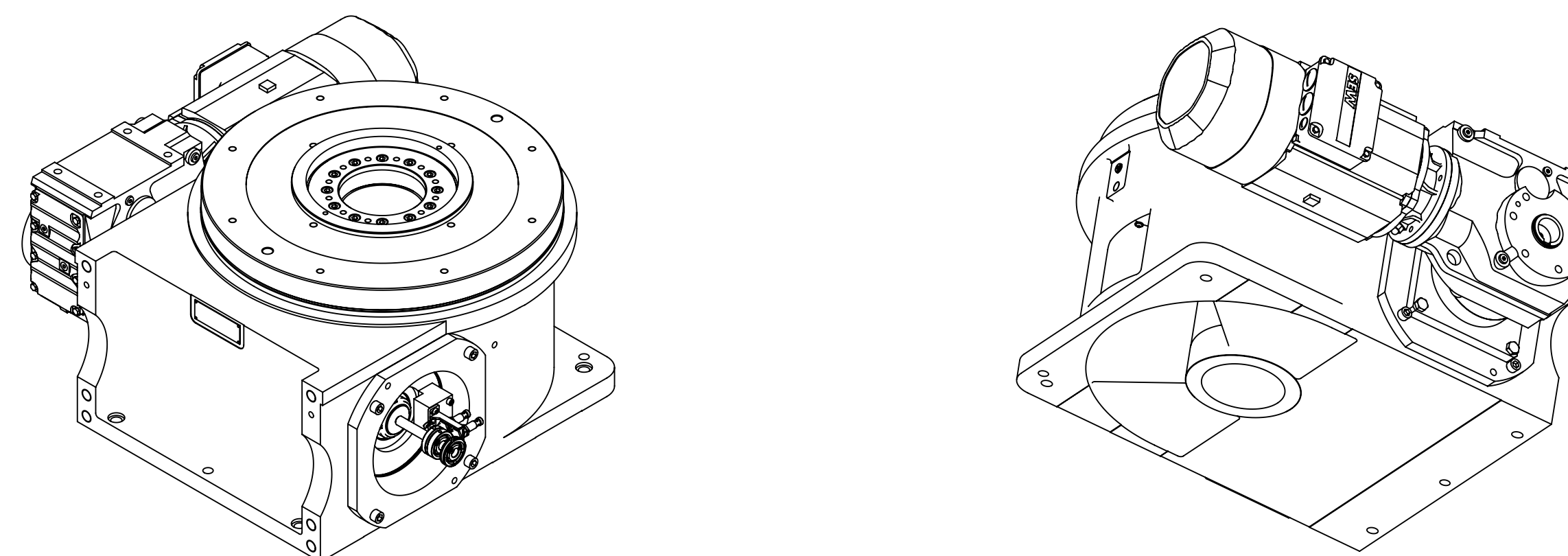

Bildliche Darstellung unverbindlich
not binding scheme
ce tableau de mesures reste sans engagement

Technische Änderungen vorbehalten
technical alterations reserved
Sous reserves de modifications techniques

FIBRO URBEWAHRUNG UNBENUTZTE KANTEN GEBROCHEN Break off sharp corners 0,4 x 45°		Projektion / Projection DIN ISO 128-38 Werkstoff / Material A4	Gewicht / Weight (kg) Format DIN A0	Maßstab / Scale 1:4
Urspr. Zeichnung / Source drawing SO 1445(2)		Datum / Date 12.03.2019	Name / Name Zick, Waldemar	Beschreibung / Designation / FIBROTOR BMZ
Abgabemerkmal General delivery DIN ISO 2768 mS		Blatt / Sheet 4	Blatt / Sheet 4	Beschreibung / Designation / FIBROTOR assembly drawing
11.04.2022 Cebel, Anja		Blatt / Sheet 1	Blatt / Sheet 1	Beschreibung / Designation / EM/ER.17.0558.1.142.XX.0.0.X
Oberfläche / Surface DIN ISO 1302		Blatt / Sheet 1	Blatt / Sheet 1	Beschreibung / Designation / EM/ER.17.0558.1.142.XX.0.0.X
FIBRO GmbH Waldenstrasse 41-43 D-74189 Warendorf T +49 2534 73-0 F +49 2534 73-218		Blatt / Sheet 1 von 1 of 1	Blatt / Sheet 1 von 1 of 1	Beschreibung / Designation / EM/ER.17.0558.1.142.XX.0.0.X