

Mögliche Antriebsanordnungen / possible drive arrangements

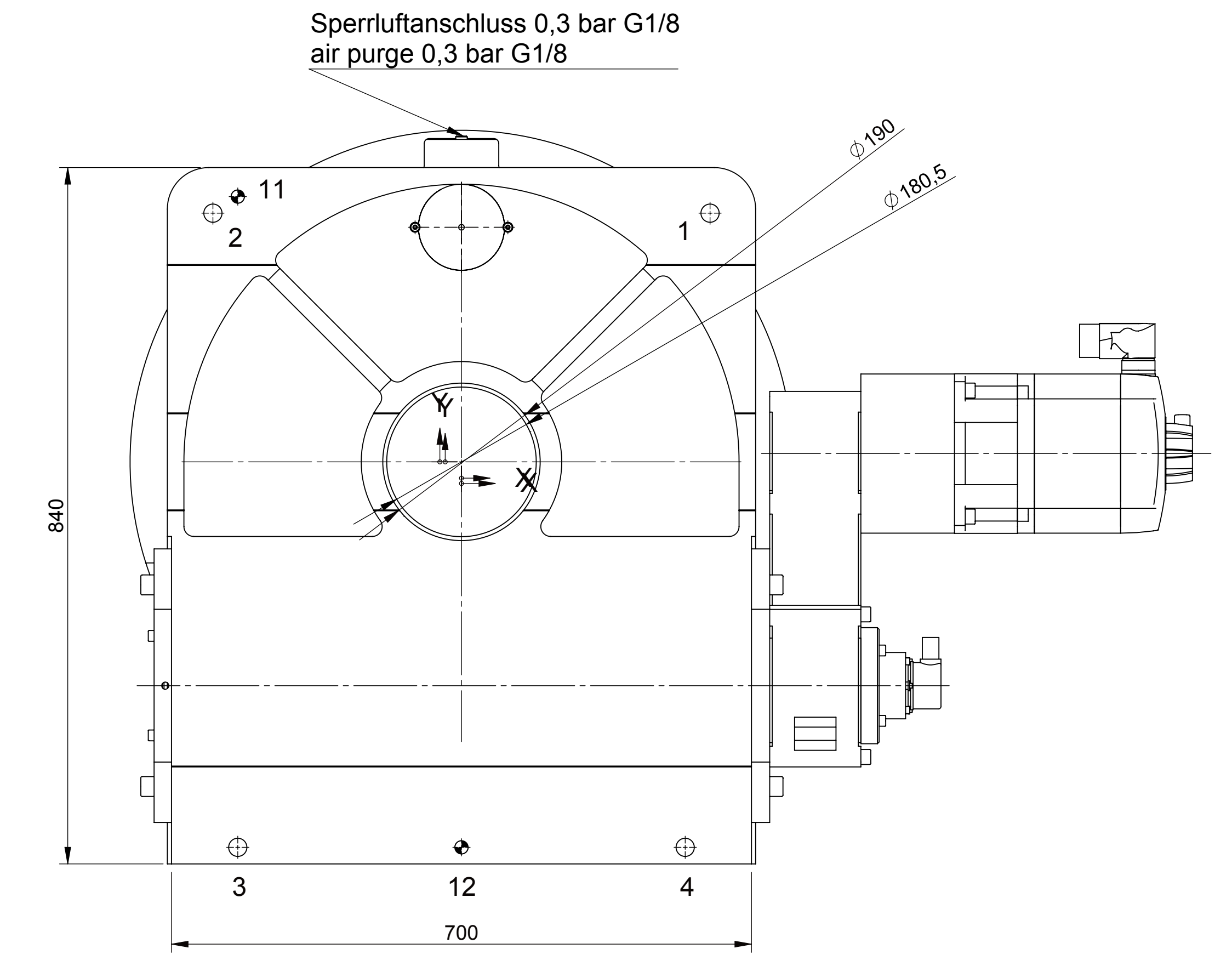

Pos.	X	Y	Beschreibung / Description
1	300	300	TYP S - D1 Ø22 (BT 35) - D2 Ø39 T 5 - Ø 0,2
2	-300	300	
3	-270	-465	
4	270	-465	

Pos.	X	Y	Beschreibung / Description
11	-270	320	TYP SSL - D Ø16H7 BT 35 - Ø 0,03
12	0	-465	

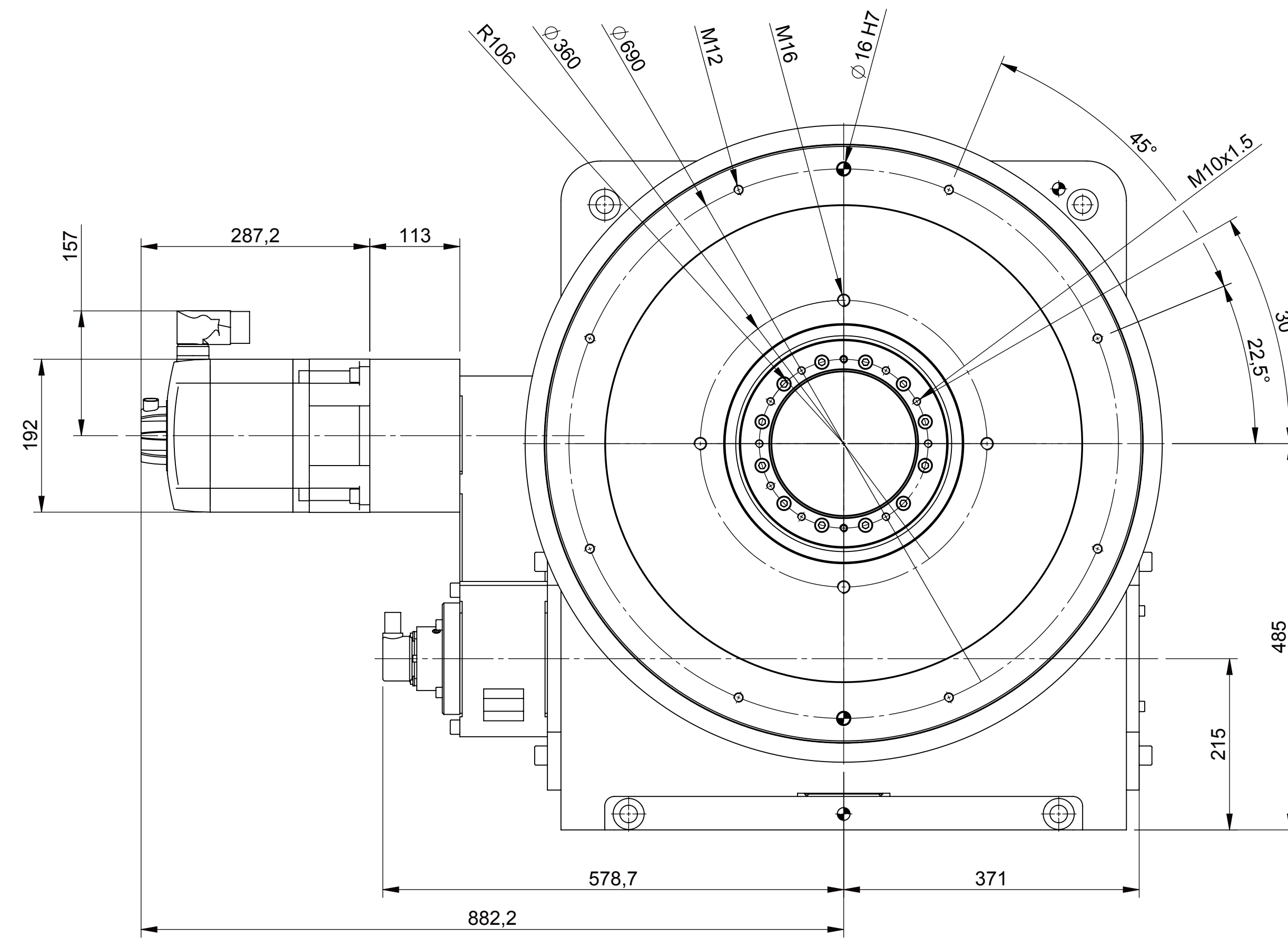
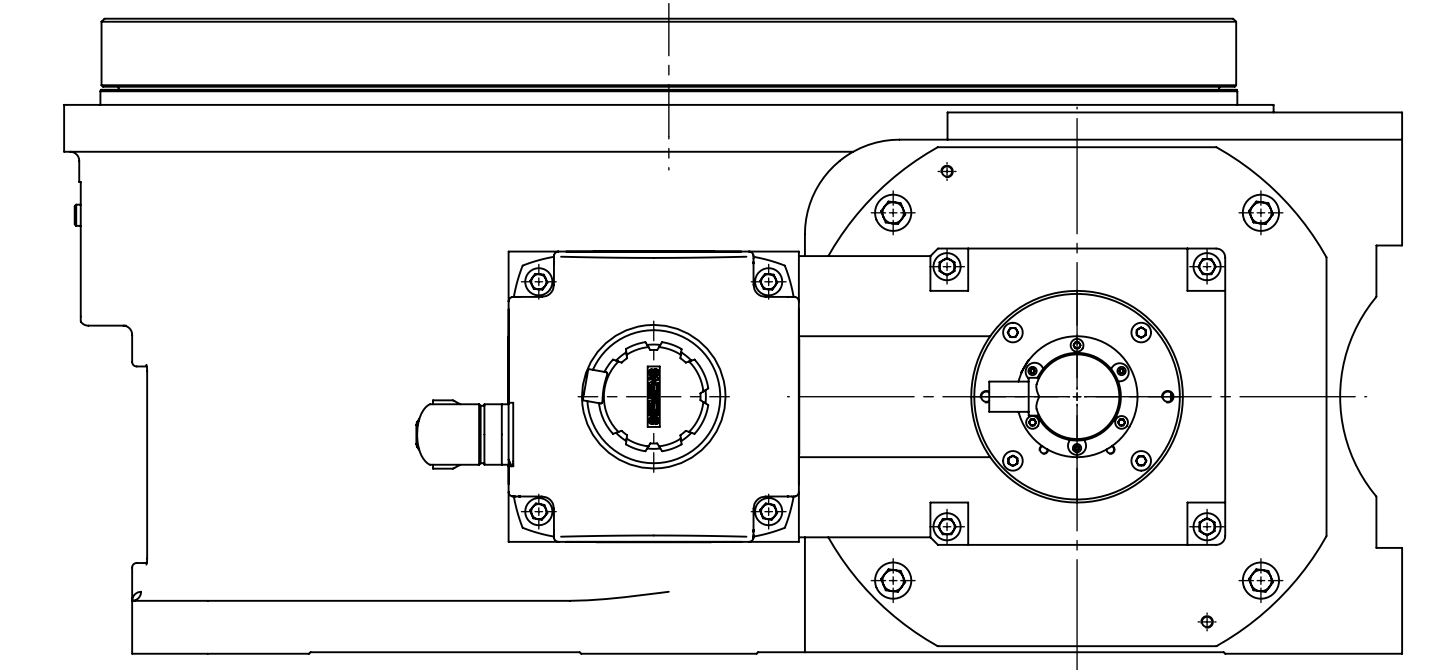
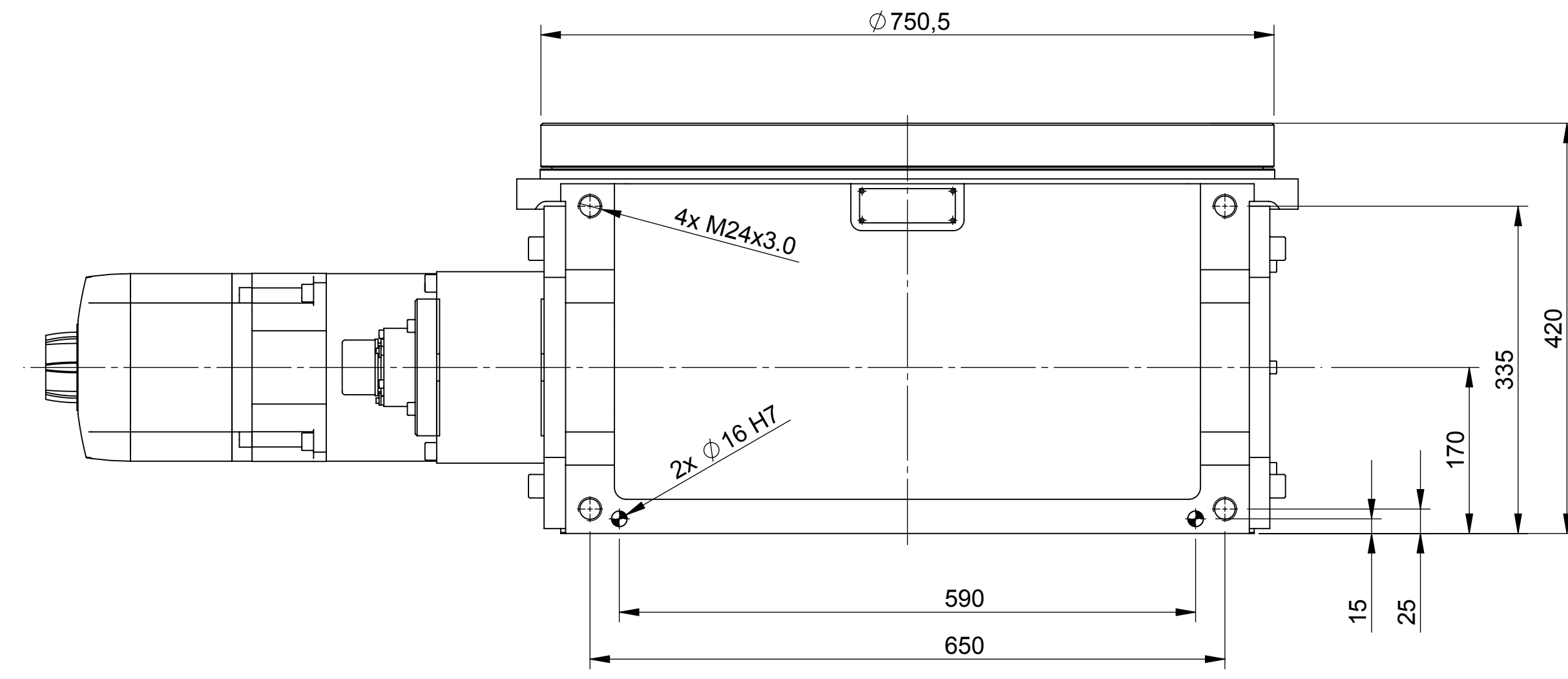
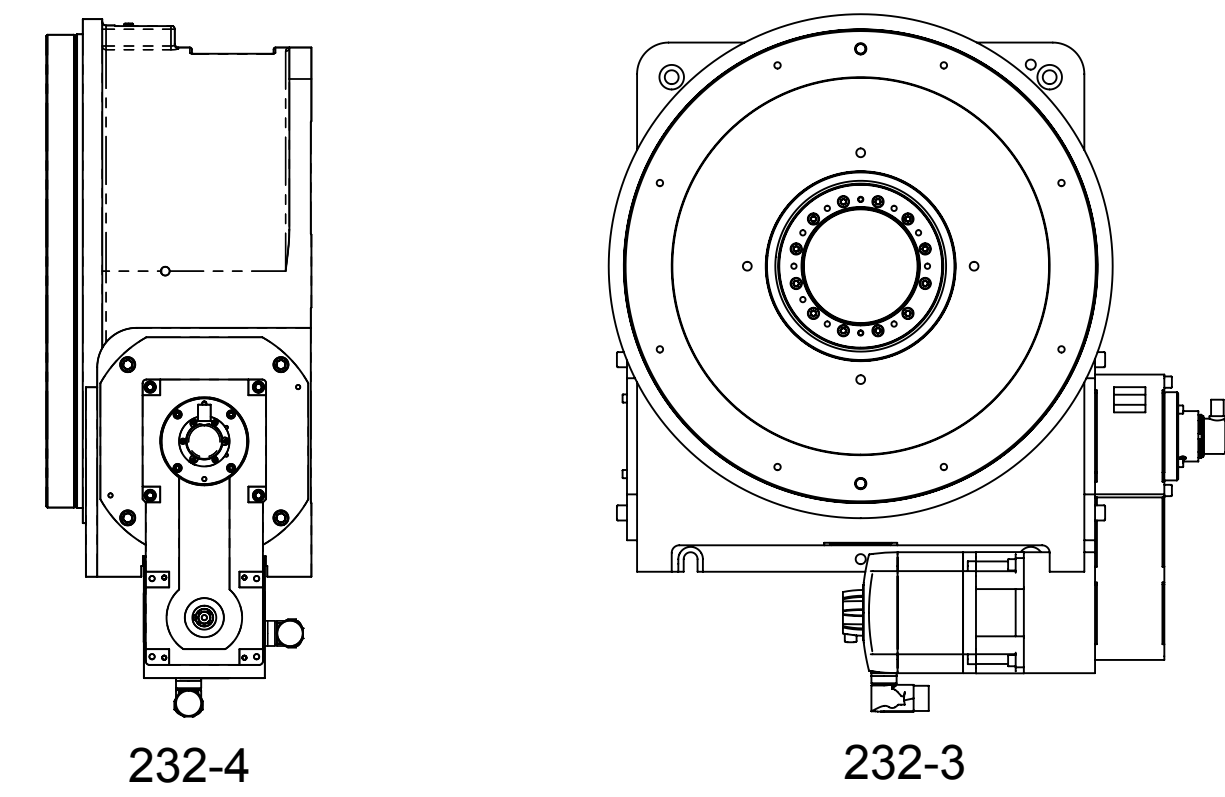
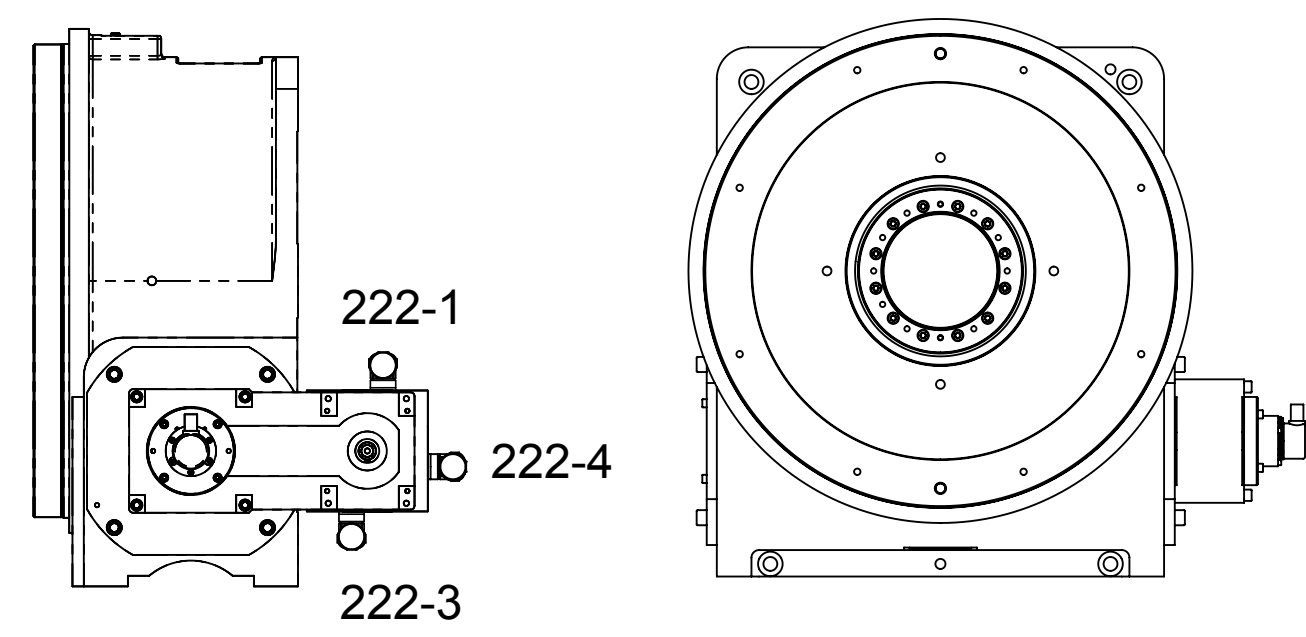
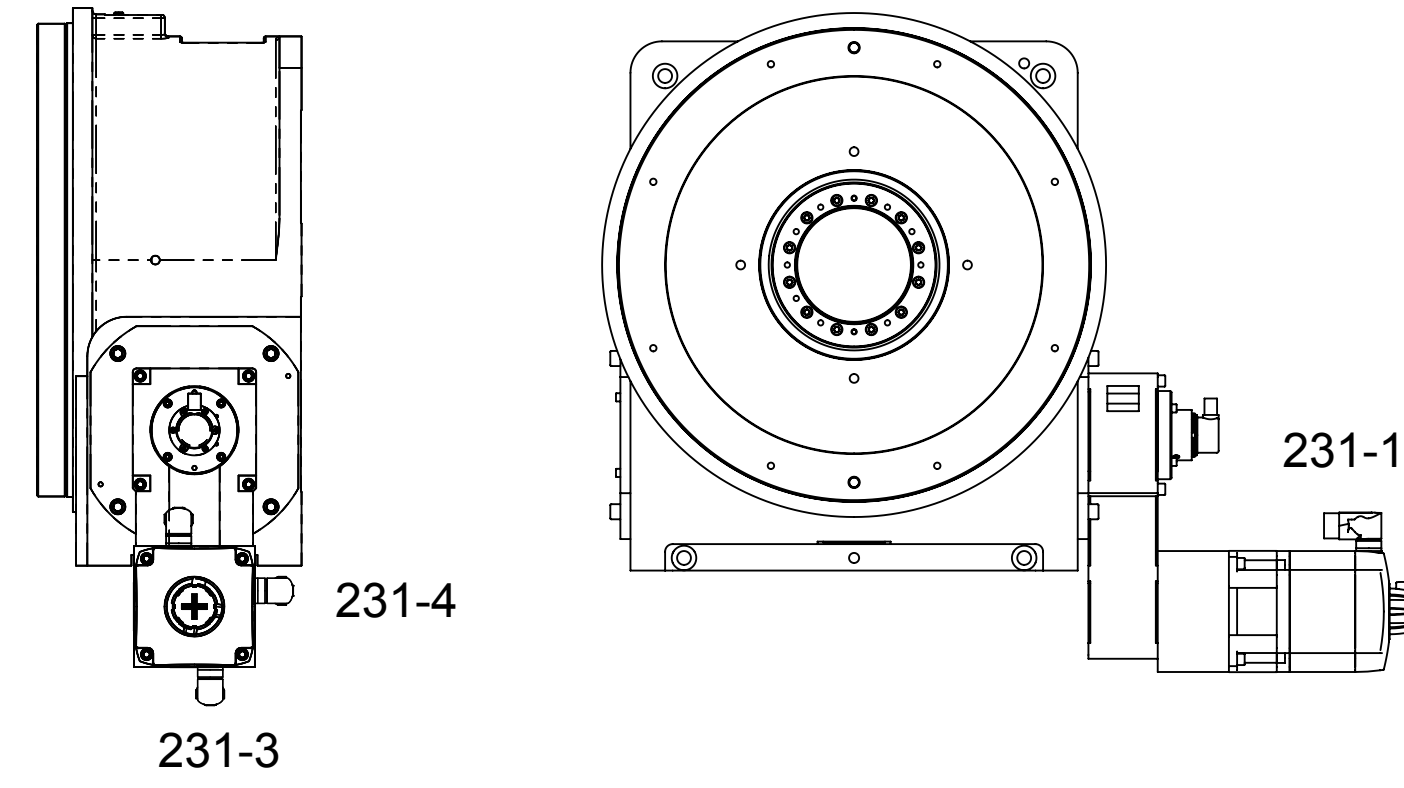
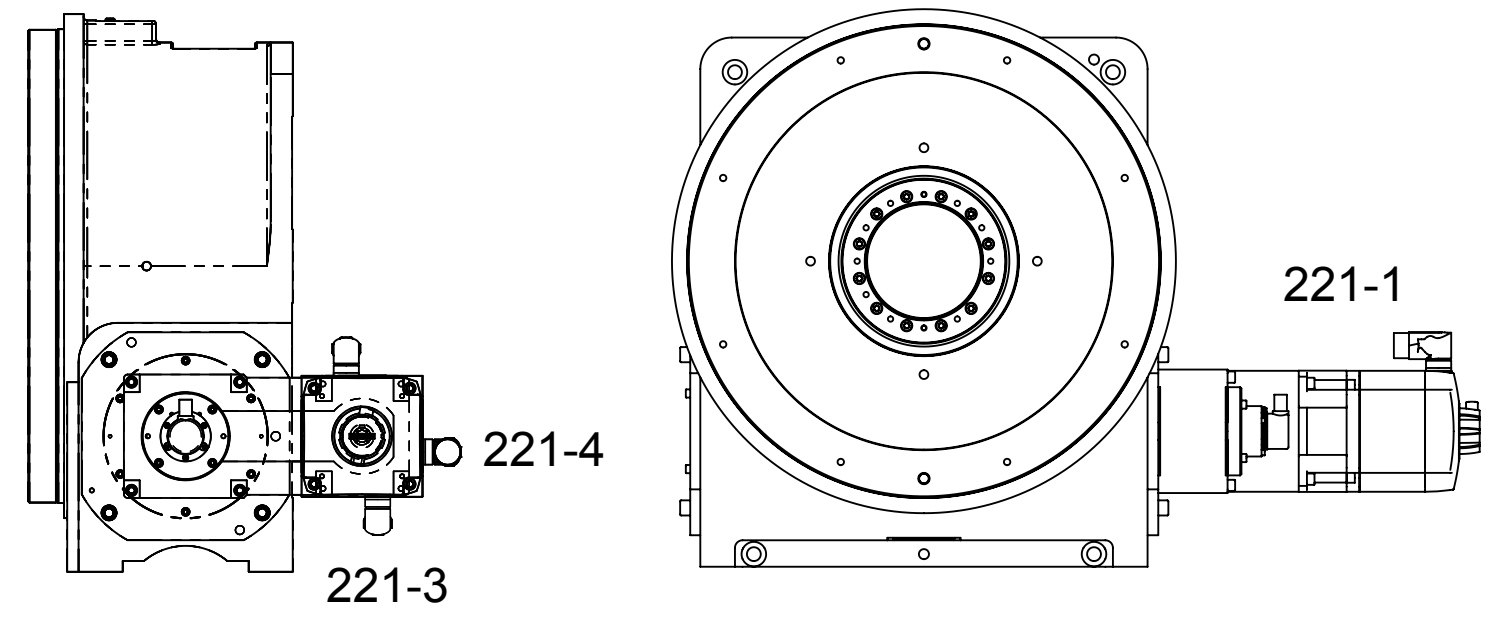
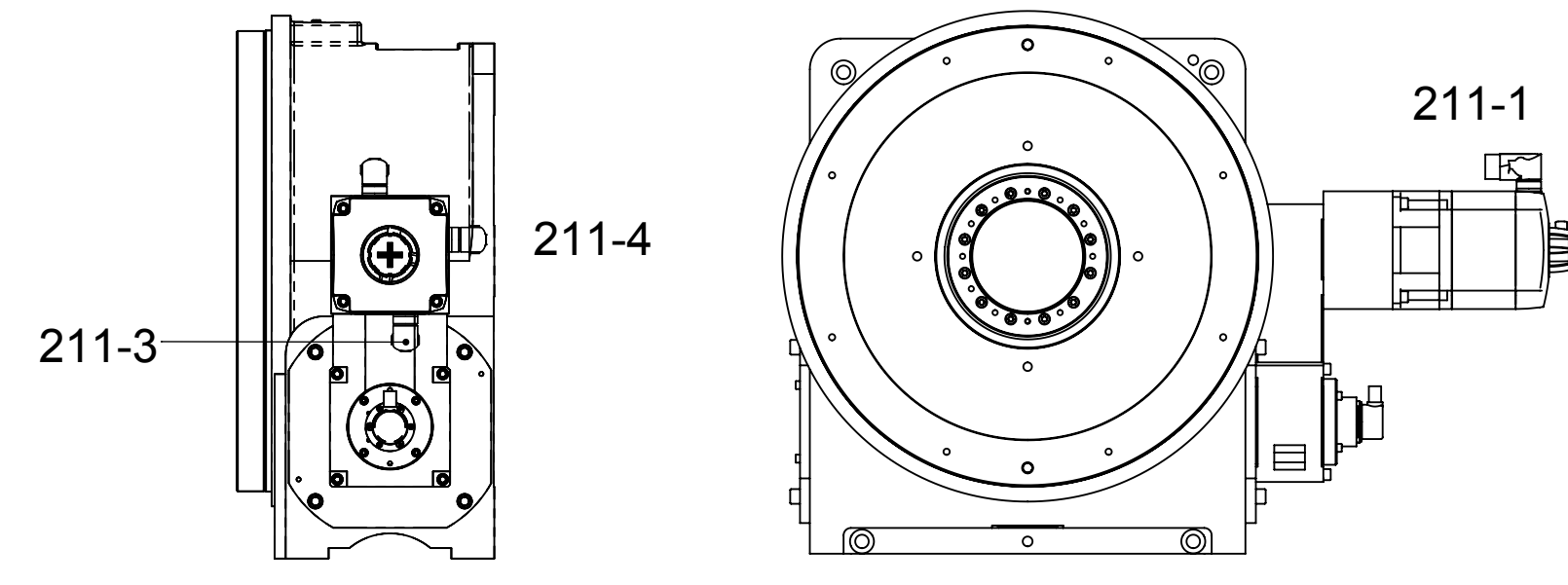
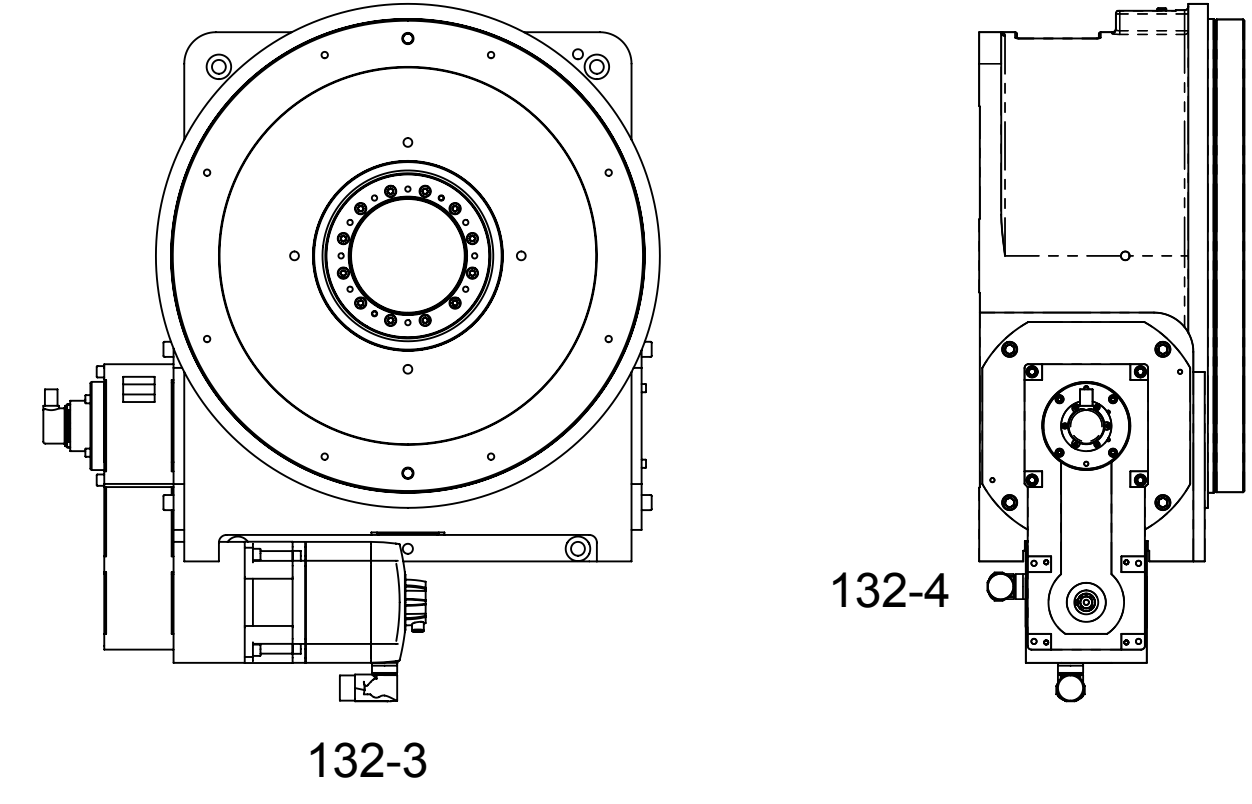
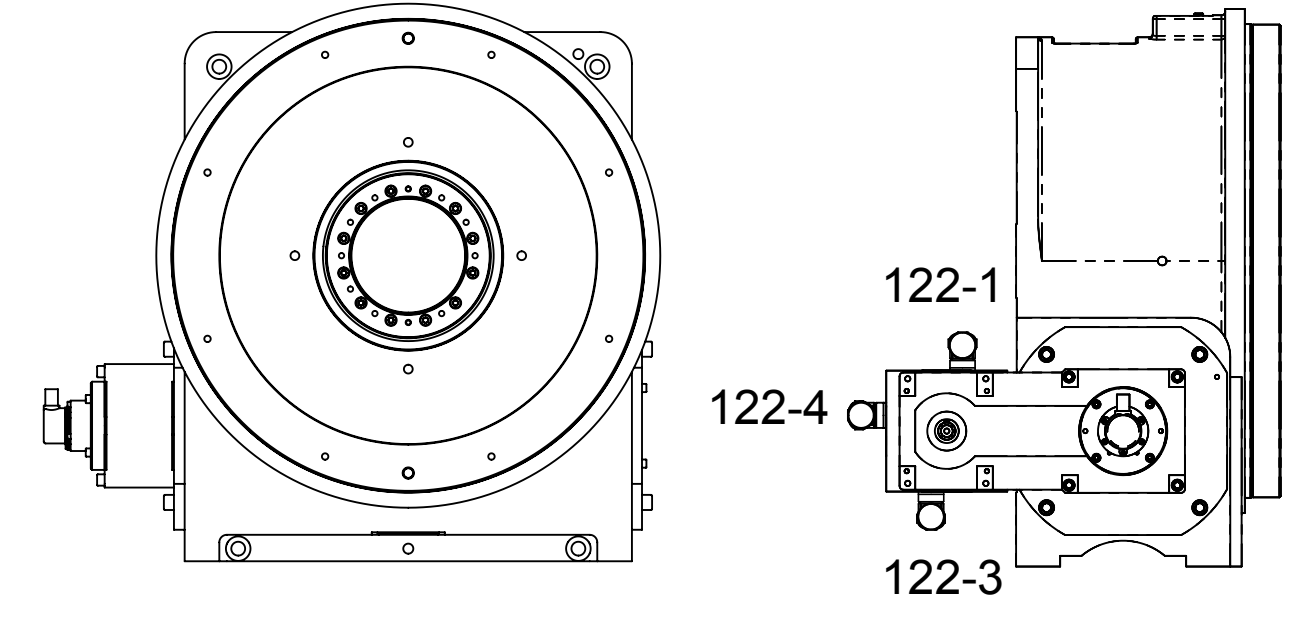
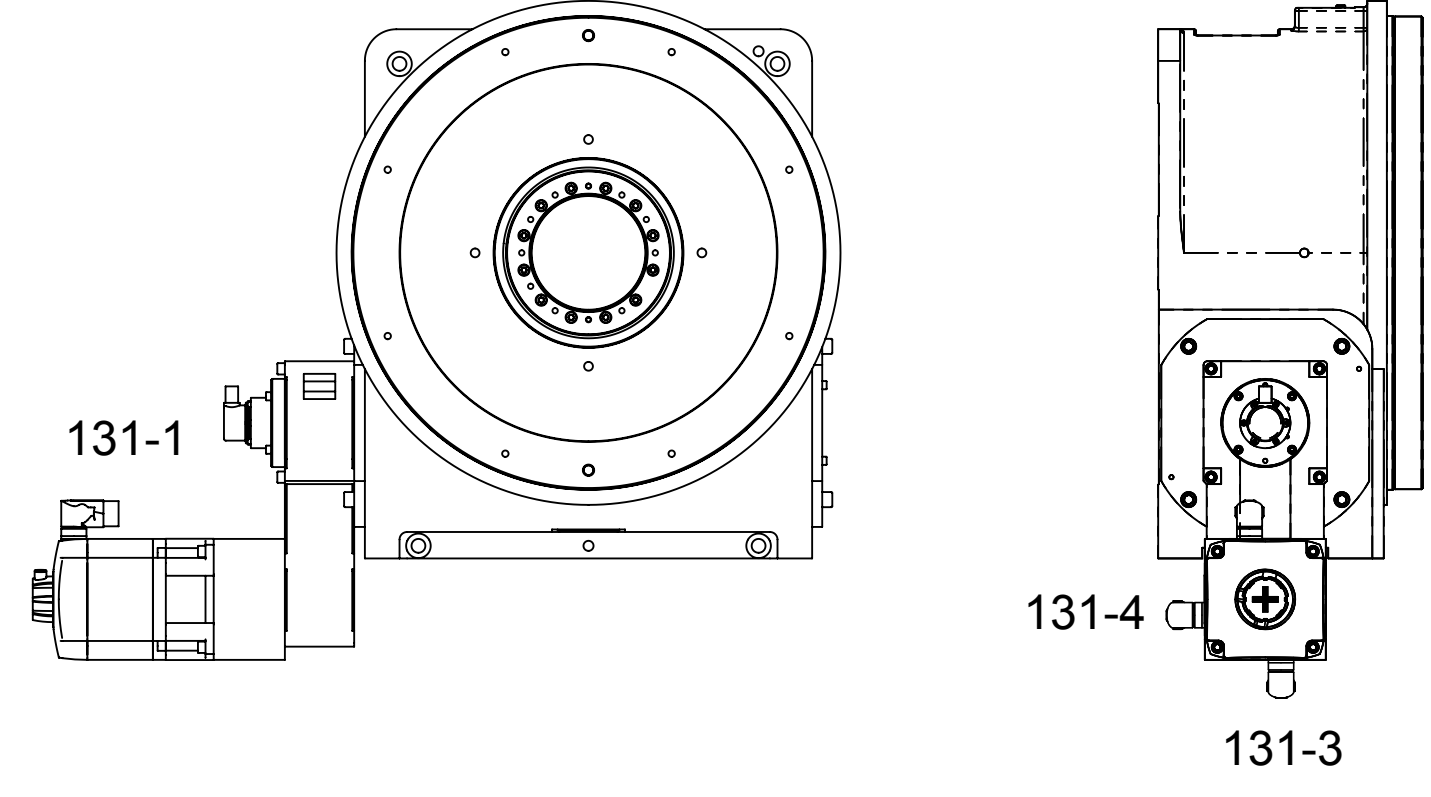
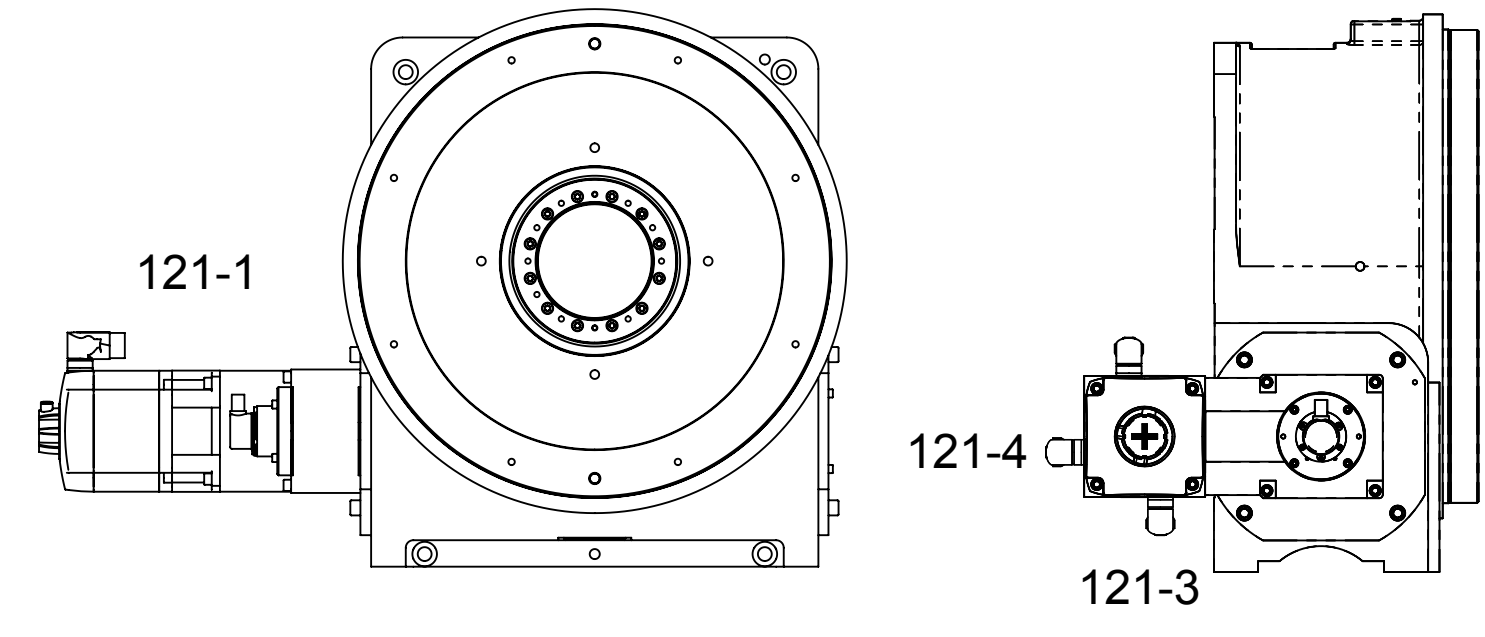
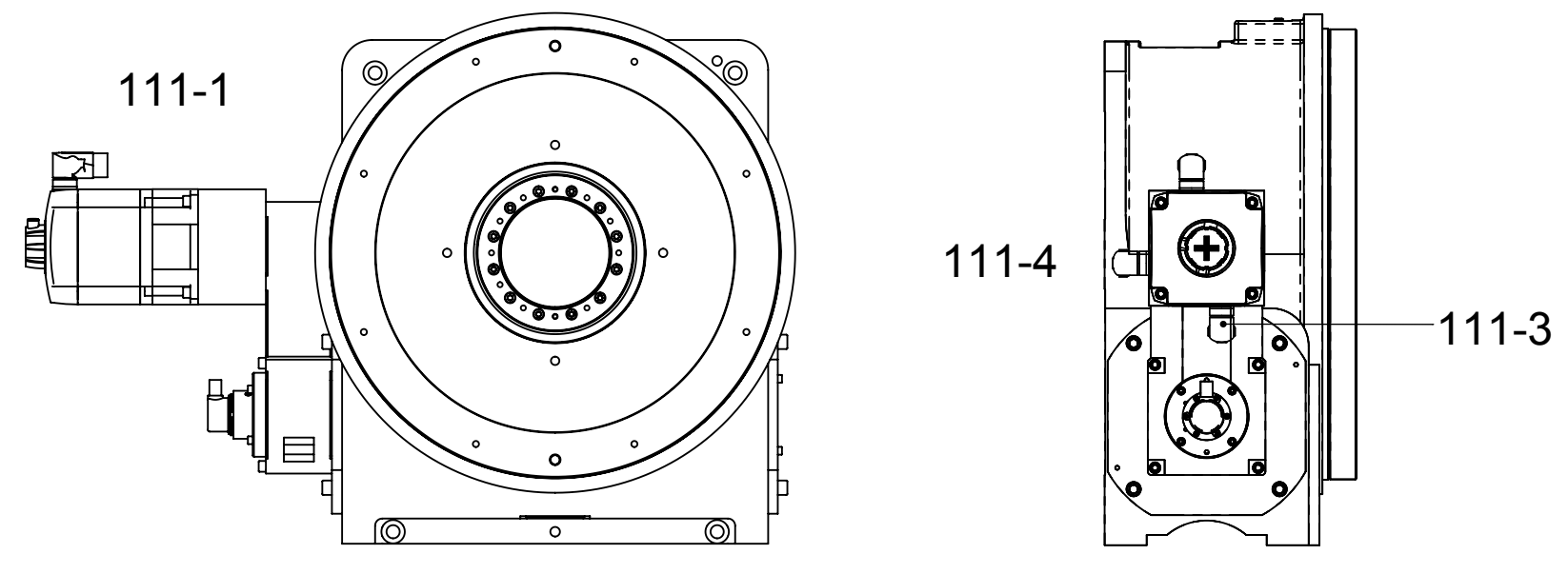
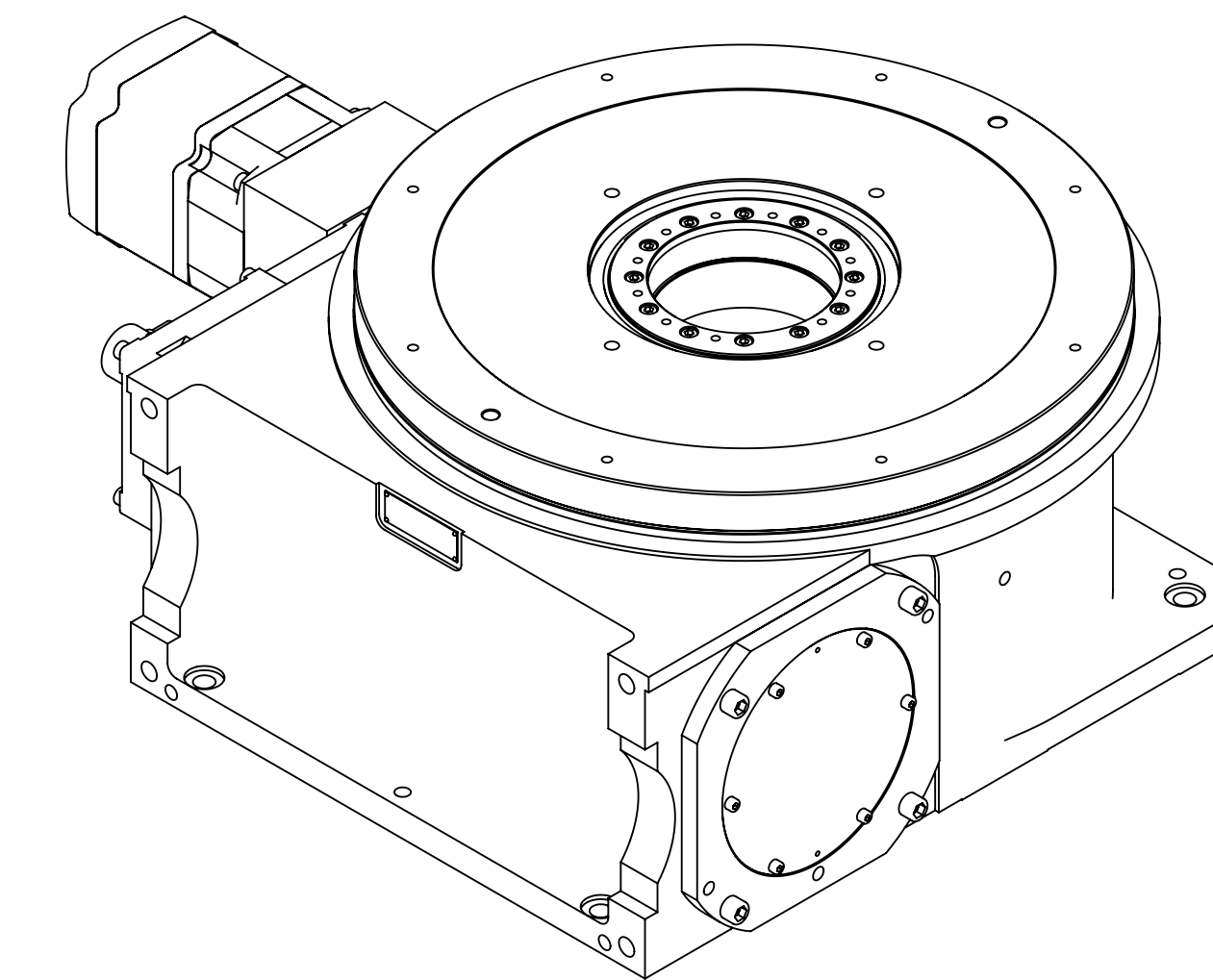
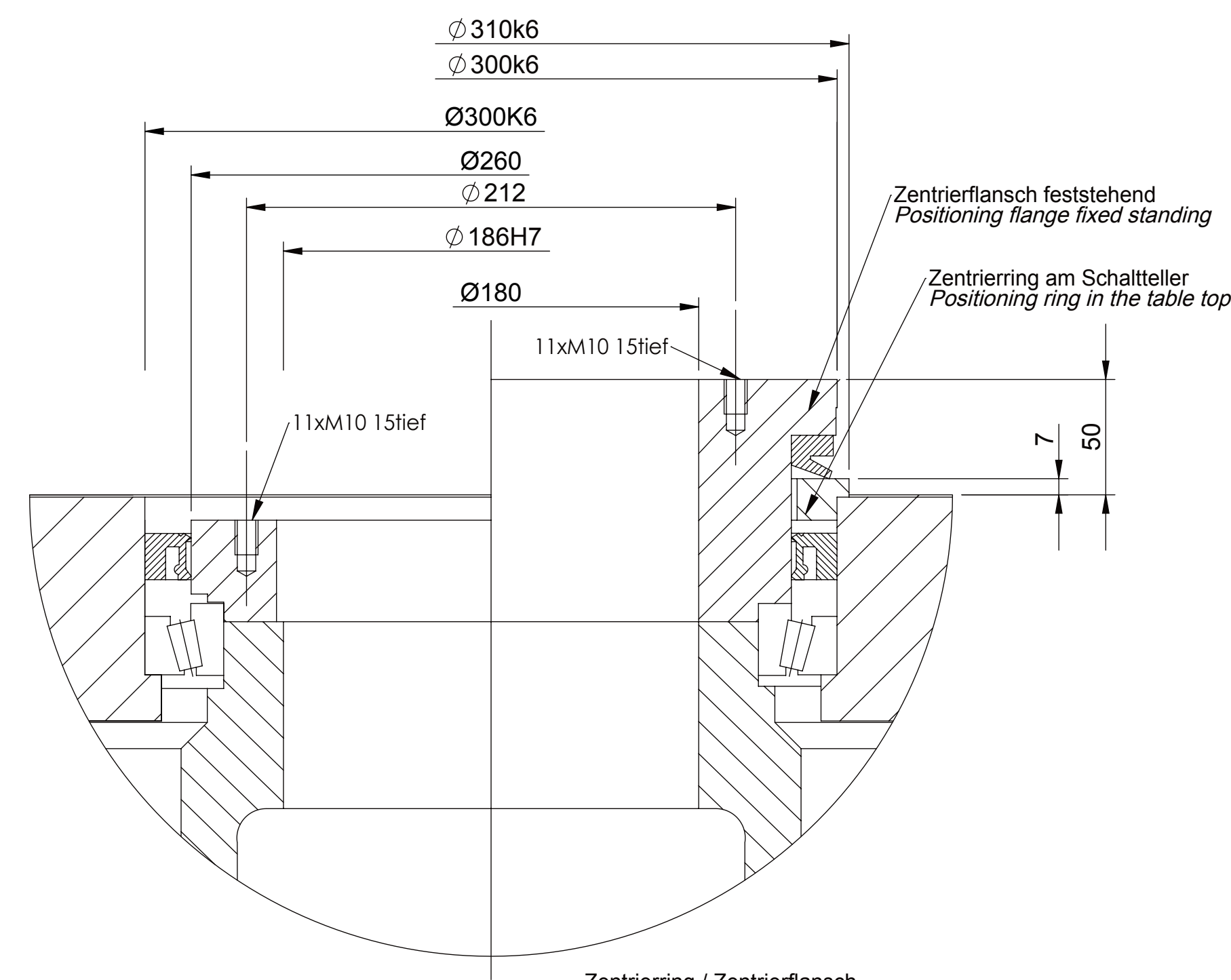

Bildliche Darstellung unverbindlich
not binding scheme
ce tableau de mesures reste sans engagement

Technische Änderungen vorbehalten
Technical alternations reserved
Sous reserves de modifications techniques

FIBRO Unbearbeitete Kanten gebrochen Break off sharp corners 0,4 x 45° Projektion / Projection: 1. bis 2. Winkel
Urspr. Zeichnung / Source drawing Werkstoff / Material: **FIBROTOR BMZ**

Abgezeichnet/Drawn: [Signature]	Datum/Date: 09.03.2016	Name/Name: Waldemar
Gezeichnet/Drawn: [Signature]	Dr. Nr.: 401	Dr. Nr.: 401
Geprüft/Checked: [Signature]	Dr. Nr.: 401	Dr. Nr.: 401
Freigegeben/Released: [Signature]	Dr. Nr.: 401	Dr. Nr.: 401

FIBRO GmbH
Waldenstrasse 41-43
D-74189 Württemberg
T +49 7134 / 73 0
F +49 7134 / 73 218

Artikel-Nr. / Article code: **4-818-928-00NC**

Blatt / Sheet 1 von / of 1